

Installation Process

1

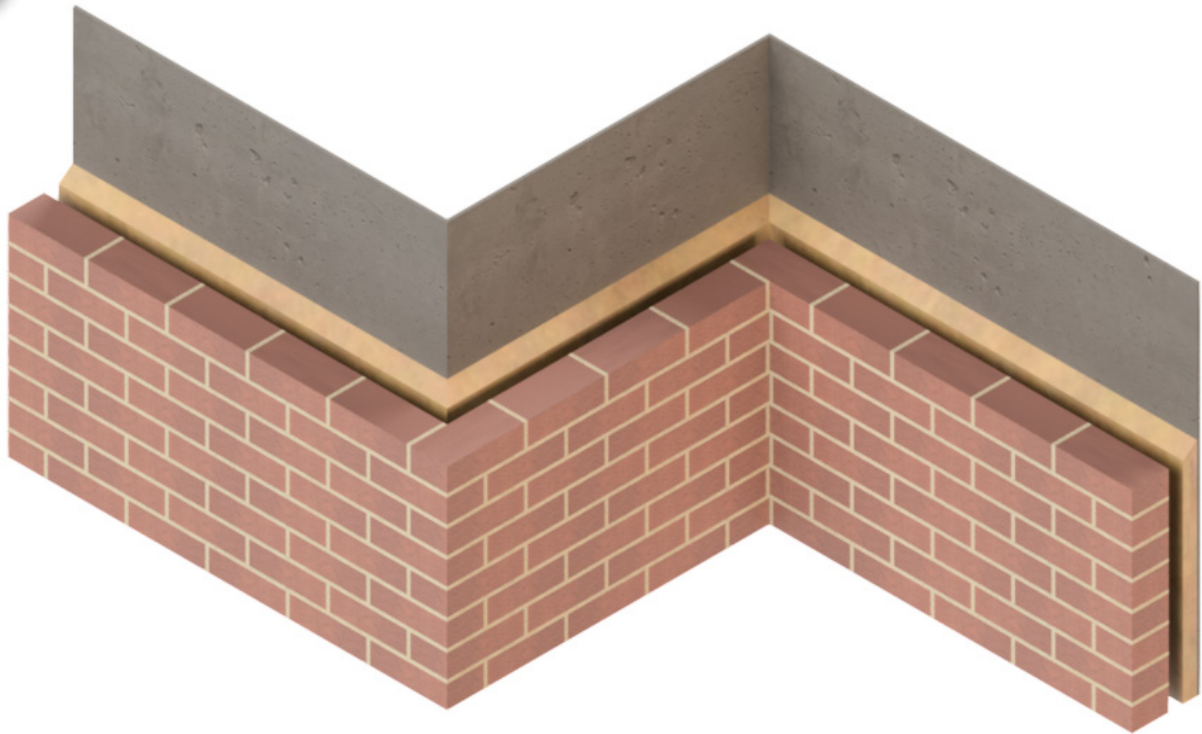

Safety procedure

The Safe Seal stainless steel cavity tray system is produced from stainless steel sheet. As with all stainless steel fabrications, these will present sharp edges. Suitable personal protective equipment should be worn at all times during handling and installation. In every case installation should be entrusted to appropriately qualified and experienced persons. Normal handling precautions should be taken to avoid physical injury. The company cannot be held responsible for any injury as a result of using our products, unless such injury arises as a result of our negligence.

Step One

Determine which course of bricks, in the external leaf, the trays need to be installed on. We recommend installation is one brick course above the area that needs protection.

For sales or technical assistance please call

01189 753 377 or email sales@dorseys.co.uk

Installation Process

2

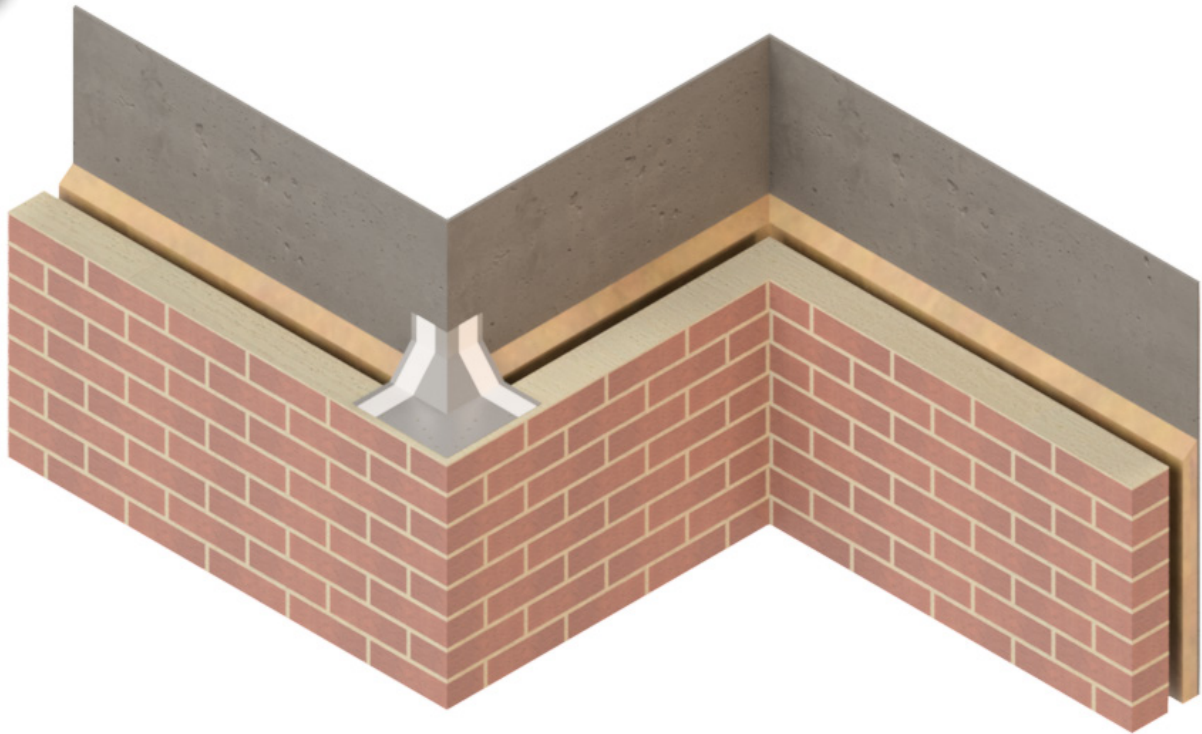

Step Two

Working corner to corner, ensure all areas being taped are clean, dust free and dry. Pre apply the double sided butyl tape to the edge that will be accepting the adjacent cavity tray. Use the applicator provided to ensure there is no gap between the tray and the butyl tape. Care must be taken in these areas to ensure no gaps are behind the butyl tape.

For sales or technical assistance please call

01189 753 377 or email sales@dorseys.co.uk

Installation Process

3

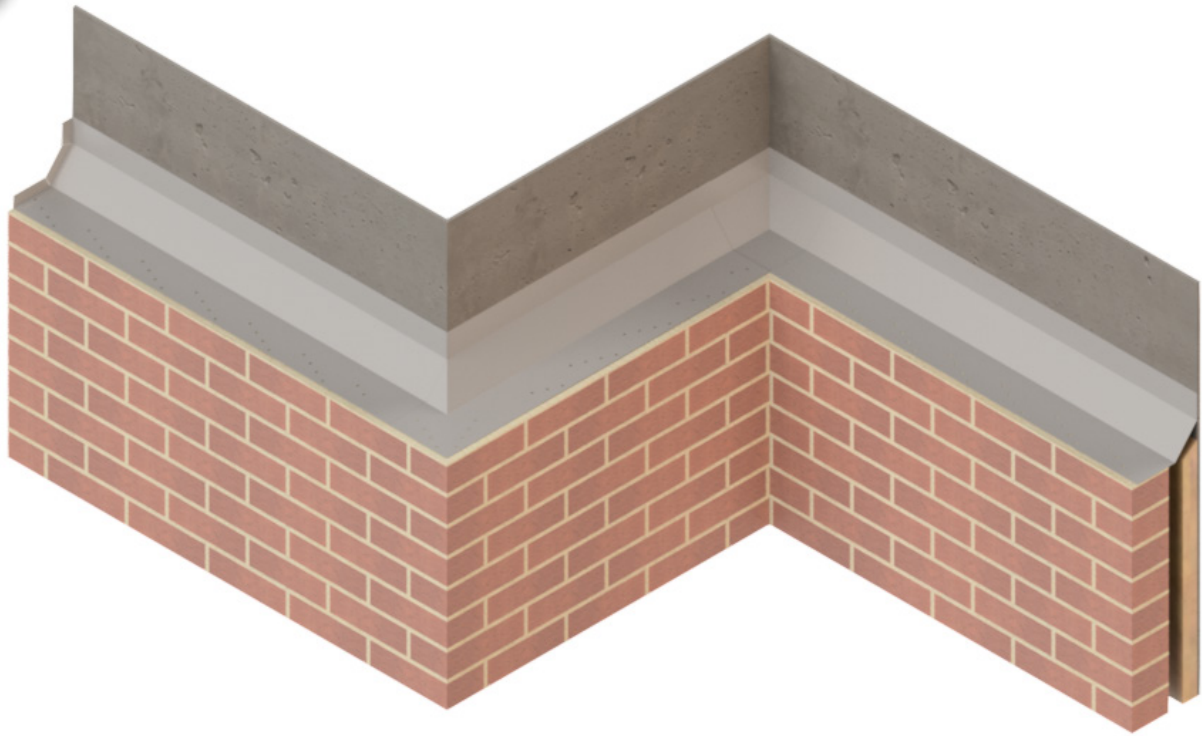

Step Three

Take a length of SafeSeal cavity tray and install on a half bed of mortar ensuring a minimum of 100mm overlap to each joint. Pressure needs to be applied to each taped joint ensuring there are no gaps between the tape and the tray - creating a watertight seal.

For sales or technical assistance please call

01189 753 377 or email sales@dorseys.co.uk

Installation Process

4

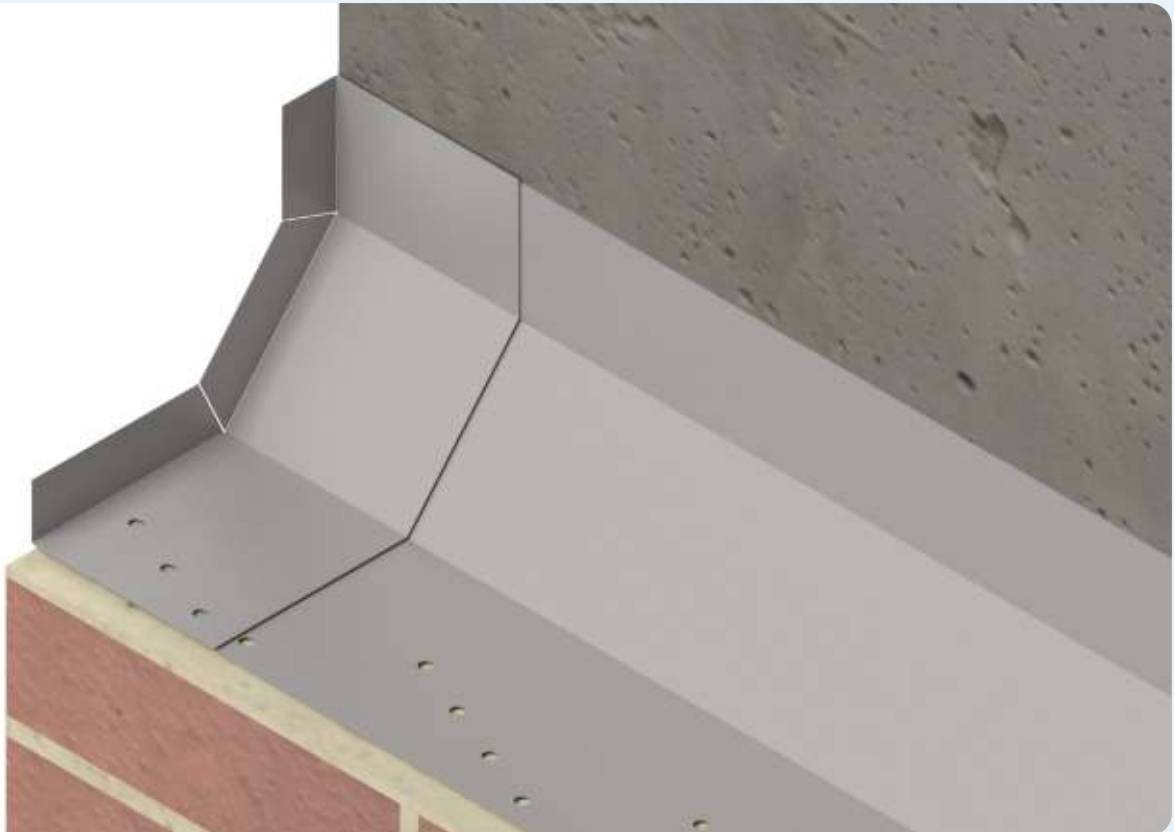

Step Four

At the end of each cavity tray run install a Safeseal stop end. The stop ends are to be installed on top of the cavity tray run and not below, apply the butyl tape as before. The stop ends are handed left and right.

For sales or technical assistance please call

01189 753 377 or email sales@dorseys.co.uk

Installation Process

5

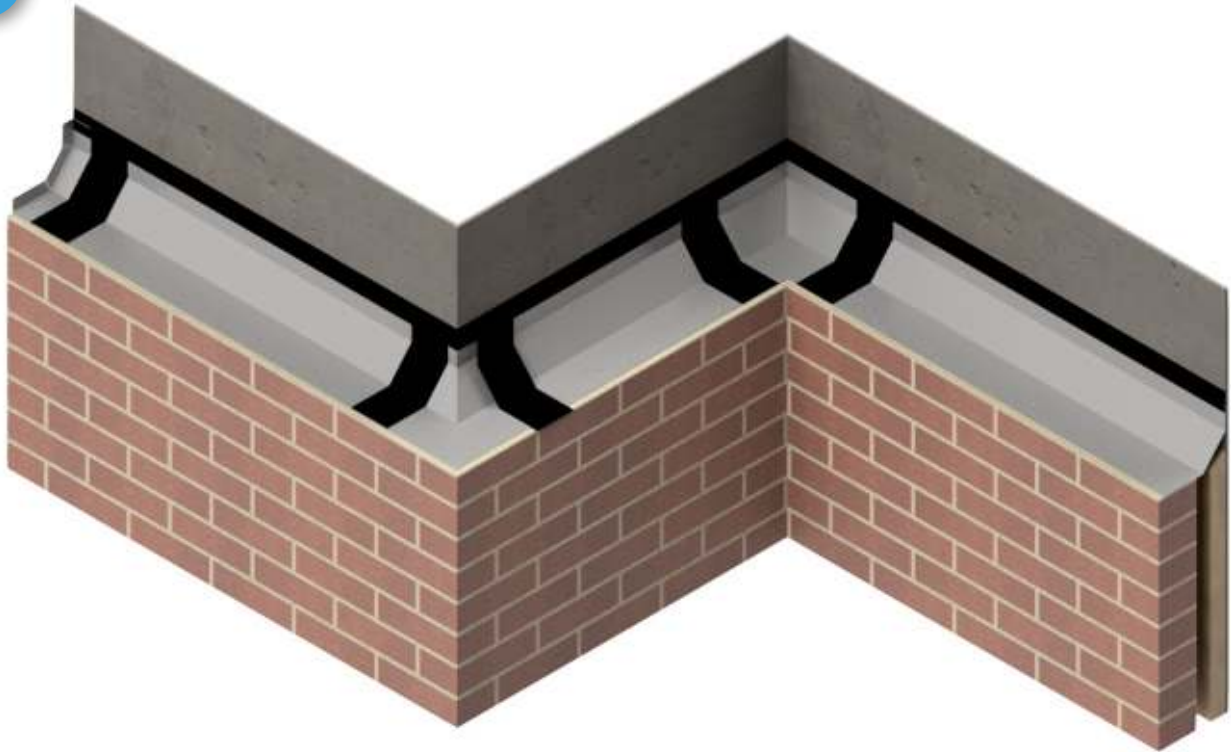

Step Five

Apply the DAFA Moisture Barrier Tape over the lap joint. Use the applicator provided to ensure the tapes follow tightly to the profile of the trays, especially where the trays change direction. Pressure needs to be applied to each taped joint ensuring there are no gaps between the tape and the tray - creating a watertight seal.

Moisture barrier taping procedure

- Apply one strip of barrier tape over the top of the joint vertically using the applicator to ensure it fits tightly to the profile of the tray
- Apply two more strips of barrier tape either side of the first piece ensuring both overlap the first, again using the applicator to create a tight seal against the tray.

For sales or technical assistance please call

01189 753 377 or email sales@dorseys.co.uk

Installation Process

6

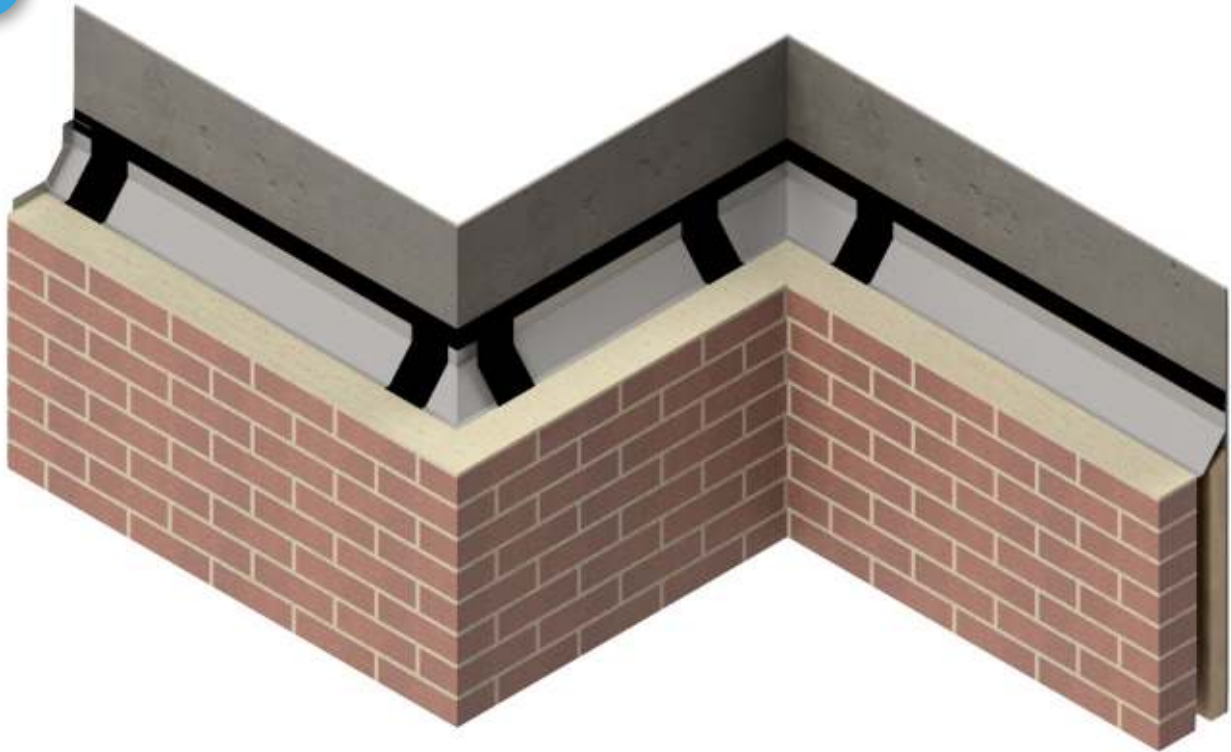

Step Six

Repeat this process on all lap joints, then apply the second layer of mortar and continue with the brickwork. Trays to be cut to length as required to ensure a minimum of 100mm overlap.

For sales or technical assistance please call

01189 753 377 or email sales@dorseys.co.uk

Installation Process

7

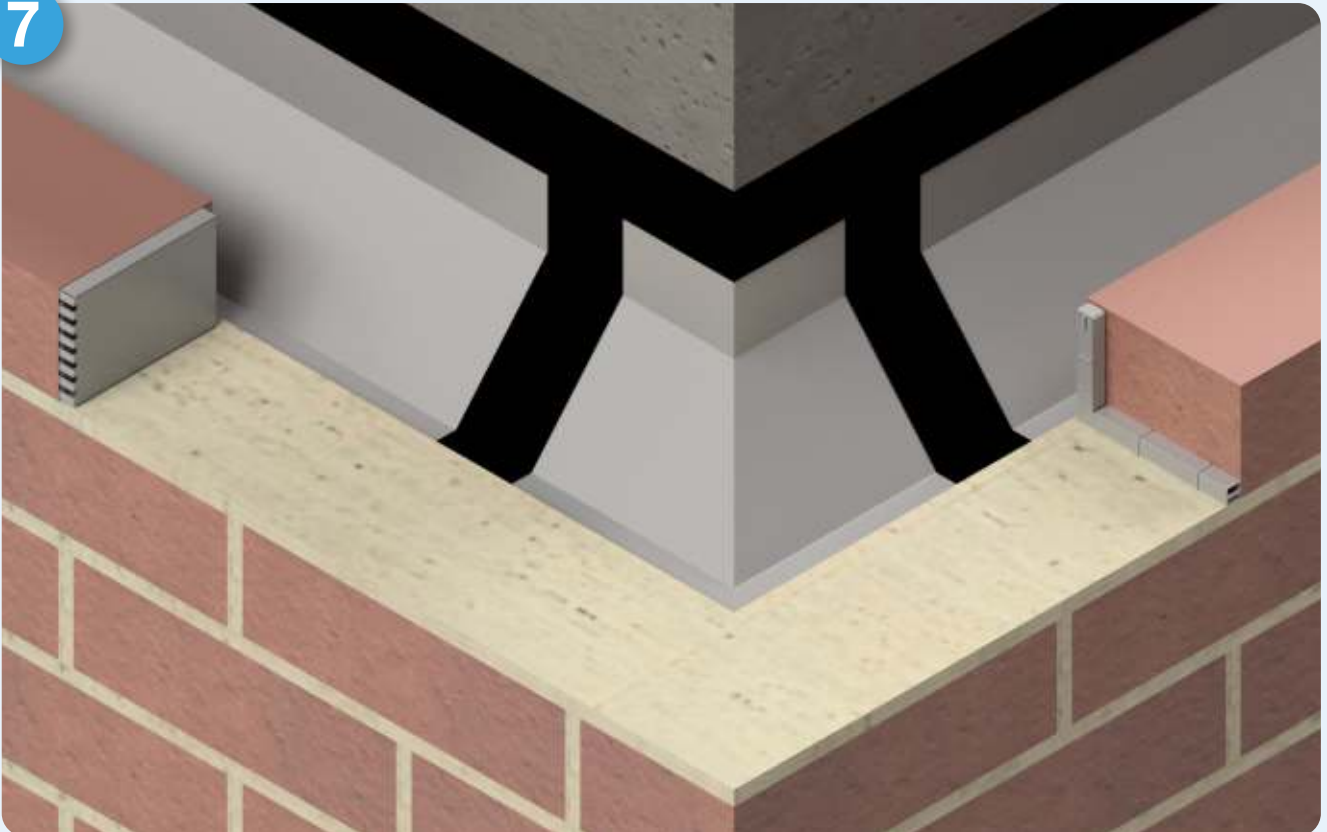

Step Seven

Ensure SafeSeal weep vents and or SafeSeal weep holes are installed within the cavity run. We recommend weeps are installed at 450mm centres above windows and doors and at 900mm centres along a cavity tray run.

For sales or technical assistance please call

01189 753 377 or email sales@dorseys.co.uk

System components

Lengths

To be cut to any length required

**SAFESEAL
CAVITY TRAY 2.5m LENGTHS**



Corners

Corners manufactured to any angle

**SAFESEAL
EXTERNAL CORNER**

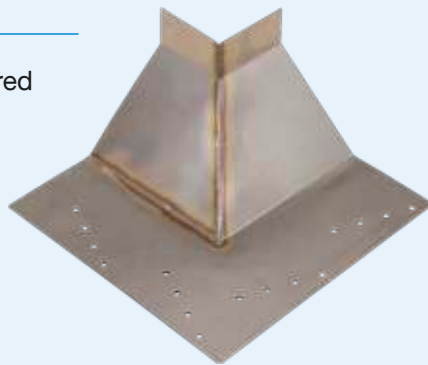

**SAFESEAL
INTERNAL CORNER**

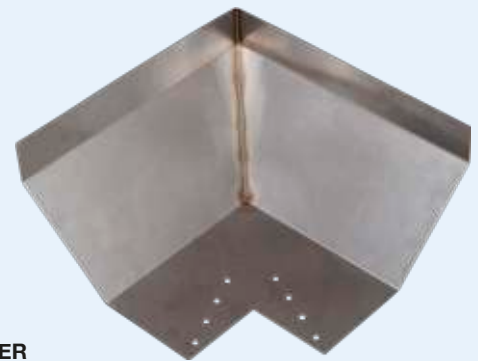

Stop ends

**SAFESEAL
STANDARD STOP END**

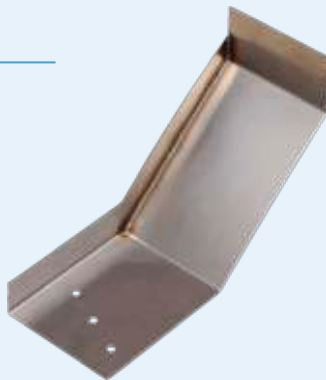

**SPECIAL SITE SPECIFIC
BRICK RETURN STOP END**

(AVAILABLE IF REQUIRED AT
ADDITIONAL COST)



For sales or technical assistance please call

01189 753 377 or email sales@dorseys.co.uk

Ancillary Products

Weepholes

SAFESEAL
WEEP VENT

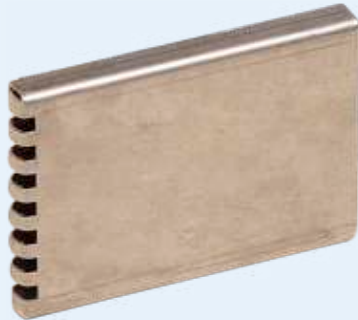

SAFESEAL
L SHAPED WEEPHOLE



Tapes

DAFA
MOISTURE BARRIER TAPE
60mm x 25m



SAFESEAL
DOUBLE SIDED BUTYL TAPE
50mm x 1.5mm x 10m



Tools

SAFESEAL
TAPE APPLICATOR TOOL

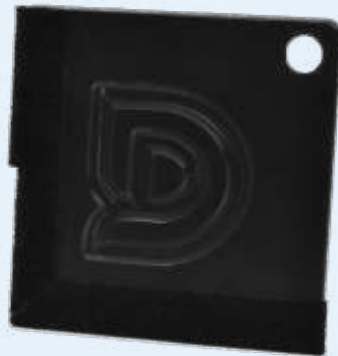

For sales or technical assistance please call

01189 753 377 or email sales@dorseys.co.uk